

2019 CDE Season

Career Development Events

Team Coaches

- Mrs. Sadler
 - Horse
 - Poultry
 - Vet Med
 - Cotton
- Mrs. McKinney
 - Dairy
 - Forages
 - Livestock
 - Meats
- Mrs. Cox
 - Entomology
 - Floriculture
 - Nursery/Landscape
- Mr. Rodriguez
 - Ag Mech
 - FBM
 - Wildlife
 - Wool

Remind 101

Text: @cdesd

To: 81010

- Ag. Mech:
- Ento: @cyfaire
- FBM:
- Floral: @cyfairflo
- Forages/Cotton: @cfforage
- Horse: @cfhorsecde
- Livestock: @cflj
- Meat: @cfmeats
- Nursery: @cyfairnu
- Poultry: @cfpoultcde
- Vet Med: @cfvetmedcd
- Wildlife:
- Wool:

Never miss a remind!

1. Download the remind 101 app.
2. Click on the gear (settings)

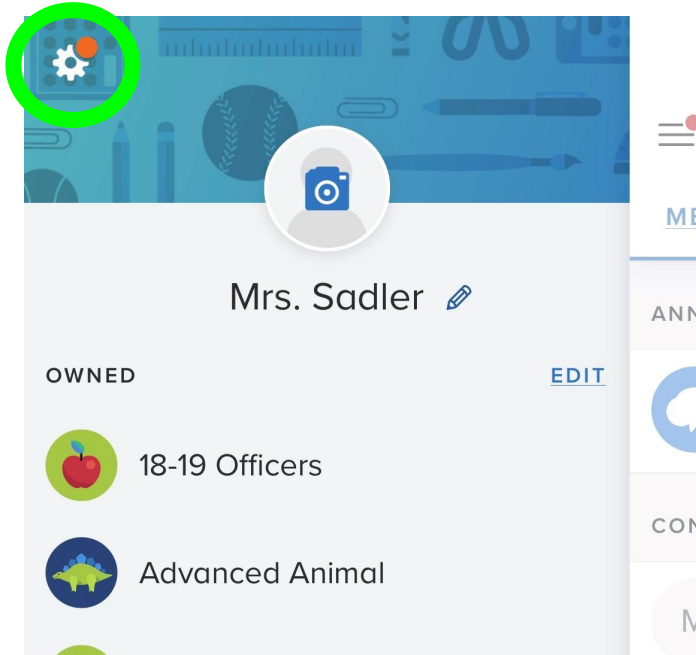

3. Click on the white bell. This will take you to your settings to change your notifications.

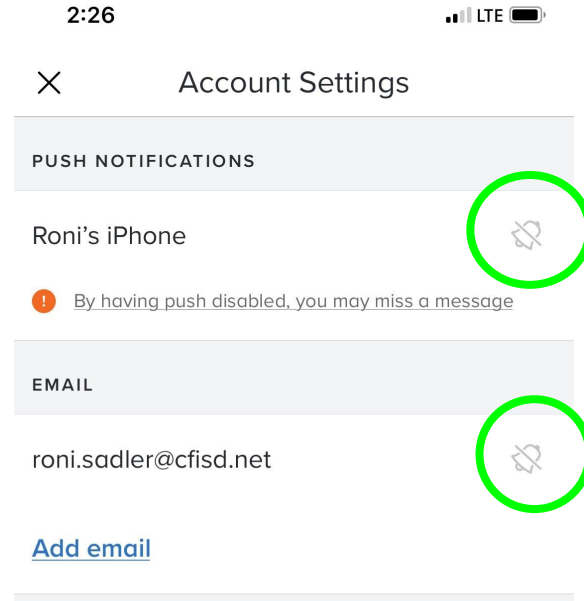

Never miss a remind!

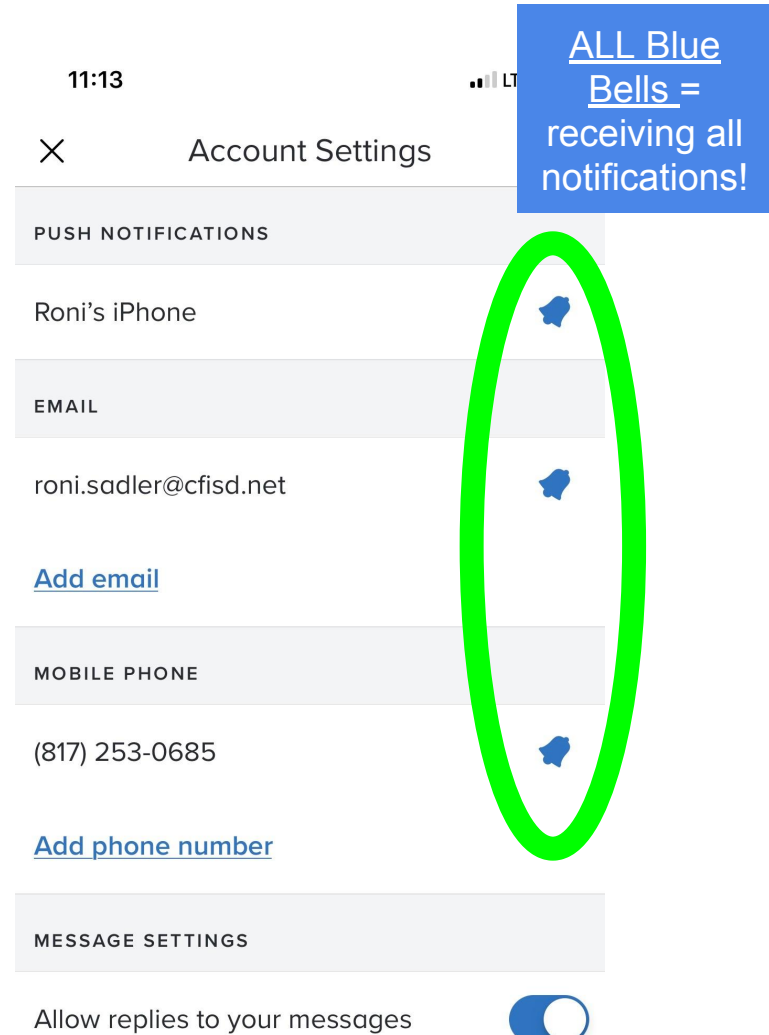
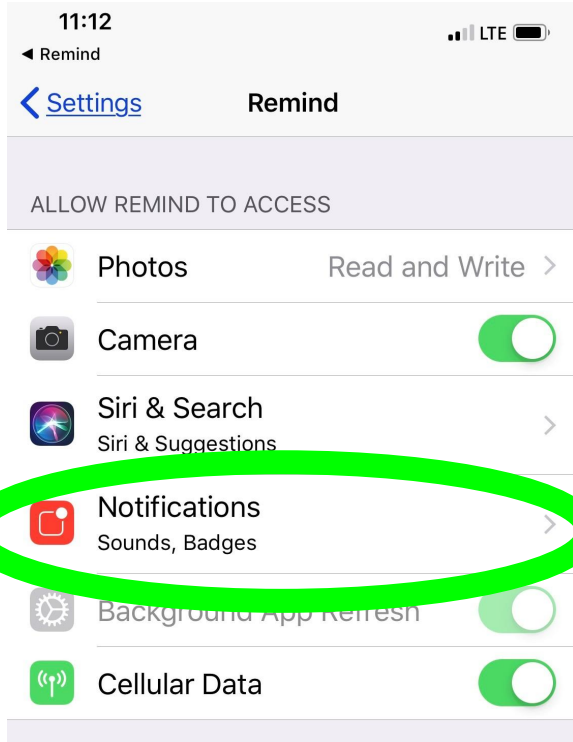

CDE Team Member Expectations

General Rules

- Students must attend 90% of all practices.
- Students must be eligible, according to the standard UIL rules, “No Pass No Play”, to participate in any contests.
- Students must be a member in “good standing”.
- All school policies and student code of conduct rules will be in effect.
- Students will “make the team” based on contests scores, practice attendance and attitude during the season.
- Students who attend 2 or more practices for one team may NOT switch teams until the beginning of next school year.

CDE Team Member Expectations

Dress Code

- Dress code for CDE contests and practice contests is a collared shirt (polo style or button up), jeans (in nice condition, no rips or tears), closed toe, closed heel shoes and no hats. Vet. Med. CDE Team will wear solid Maroon Scrubs and closed toed shoes. FBM will wear indoor official dress.
- Discrepancies in dress code will be addressed by the ag teacher. The ag teacher's decision is final.
- Dress code for travelling will be school dress code.
- The student is not allowed to change from contest dress code without permission from the Ag teacher.

CDE Team Member Expectations

Contests

- The Ag. teacher coaching each team will make the ultimate decision regarding whether a team or student competes in a contest. This decision is final.
- In order to be considered for a team students must attend 90% of all practice contests.
- A list of invitational and qualifying contests will be provided to each team as they become available. Students will be made aware of all contest as soon as they are available to the Ag. Teacher.
- The cost of contest entries will be covered by the student, in the fall. All spring contest entries will be paid for by the chapter.

CDE Team Member Expectations

Contest Continued

- Students will be responsible for hotel room expenses when contests are not local. Students must turn in cash or money order to their Ag.Teacher by the date specified on the parent agreement form for each trip.
- **In the event a student backs out of the contest with less than 1 week notice, the student is responsible for refunding the chapter the cost of the student's entry fee, and will not receive a refund for hotel payment, if applicable.** If the student's failure to attend causes forfeiture of the team, the student will be held responsible for the cost of the team entry. The student will be added to the fees and fines list on campus until they are resolved.
- Fees may be waived based upon extenuating circumstances as deemed appropriate by the ag teacher coaching the team.
- A contest agreement must be on file from each student participating on any CDE team. Completion of the agreement DOES NOT guarantee a position on any team, or competition in any event.

Horse Judging CDE Team

Practice is held Tuesdays and Thursdays at 6:30am.

January -

Wednesday, 1/30 - Alvin CDE Contest

February-

Friday, 2/1 - Ridge Point CDE Contest

Only the top 4 individuals with the highest average score from all previous contest will attend the contest below:

March-

Monday, 3/4 - HLSR Horse Judging

Thursday, 3/21 - Tarleton CDE Contest, Stephenville, TX

Friday, 3/29 - WT CDE Contest, Canyon, TX - Overnight

Saturday, 3/30 - Clarendon, TX - Overnight

April-

Wednesday, 4/3 - Heart of Texas - Waco

Saturday, 4/6 - AREA @ TAMU

*** This is the contest where the team can qualify for state.

Saturday, 4/27 - State Contest, TTU, Lubbock, TX

Poultry Judging CDE Team

Practice is held Tuesdays and Thursdays at 2:45

Only the top 4 individuals with the highest average score from all previous contest will attend the contest below:

January-

Saturday, 1/26 - Weimar CDE Contest

Wednesday, 1/30 - Alvin CDE Contest

February-

Thursday, 2/21 - Prairie View A&M

February-

Friday, 2/1 - Ridge Point CDE Contest

March-

Wednesday, 3/6 - HLSR Poultry Judging

Thursday, 3/21 - Tarleton CDE Contest, Stephenville, TX

Friday, 3/29 - WT CDE Contest, Canyon, TX - Overnight

Saturday, 3/30 - Clarendon, TX - Overnight

April-

Wednesday, 4/3 - Heart of Texas - Waco

TBD AREA

*** This is the contest where the team can qualify for state.

May-

Saturday, 5/4 - State Contest, TAMU

Veterinary Science CDE Team

Practice is Mondays and Wednesdays at 2:45pm.

Only the top 5 individuals with the highest average score from all previous contest will attend the contest below:

January-

Wednesday 1/23 - Online Contest, test will be taken online at practice this day.

Saturday, 1/26 - Weimar CDE Contest

Wednesday, 1/30 - Alvin CDE Contest

February-

Friday, 2/1 - Ridge Point CDE Contest

February-

Thursday, 2/21 - Prairie View A&M

TBD - Kingwood Park CDE Contest

March-

Wednesday, 3/12 - HLSR Vet. Skillathon -

(only those who paid in October will be able to attend.)

Thursday, 3/21 - Tarleton CDE Contest, Stephenville, TX -

Friday, 3/29 - WT CDE Contest, Canyon, TX - Overnight

Saturday, 3/30 - Clarendon, TX - Overnight

April-

Wednesday, 4/3 - Heart of Texas - Waco

Saturday, 4/9 - TAMU Vet. Clinic

Thursday, 4/18 - AREA - Lonestar Tomball

*** This is the contest where the team can qualify for state.

May-

Saturday, 5/4 - State Contest, TAMU

Livestock/ Dairy Judging Teams

Practice: Tuesday and Thursday Morning 6:30-7:00 am

LIVESTOCK JUDGING CONTEST

January

- 19th: Fort Worth Goat Judging contest Ft Worth, Texas (TOP 7)
- 30th: Alvin ISD CDE Invitational

February

- 1st: Ridge Point CDE Invitational

Livestock Judging Traveling Team (students ranked 1-4)

February

- 23rd-24th : East Central and San Antonio Contest ***Overnight

March

- 11th: Houston Livestock Judging Contest
- 21st: Tarleton Invitational ***Overnight
- 29th: WT Invitational **** Overnight
- 30th: Clarendon Invitational

April

- 3rd: Heart of Texas Livestock Judging Contest
- 6th Area 3 Livestock Judging Contest

May

- 4th: State Livestock Judging * IF WE QUALIFY*

Dairy Judging Traveling Team (students ranked 5-8)

March

- 16th HLSR Dairy Judging Contest
- 21st: Tarleton Invitational ***Overnight (Dairy)
- 29th: WT Invitational **** Overnight (Dairy)
- 30th: Clarendon Invitational (Dairy competing in livestock)

April

- 16th- 17th: Area 3 Dairy Judging Contest ***Overnight
- 24-25th: State Dairy Judging *IF WE QUALIFY*

Meat Judging Team

Practice: Mondays after-school from 2:45- 3:30 pm

March

- 3rd Houston Livestock Show and Rodeo Meat Judging Contest
- 21st Tarleton Invitational ***Overnight
- 28th-29th WT Invitational ***Overnight
- 30th Clarendon College Invitational

April

- 4th Area 3 Livestock Judging Contest

May

- 5th State Meat Judging *if we qualify*

Floriculture

Practice Tuesdays & Thursdays at 6:30am

January

Saturday, 1/26 - Wildcard Invitational CDE Contest (Weimar/Columbus)

Tuesday, 1/29 - Klein CDE Contest

February-

Friday, 2/1 - Ridge Point CDE Contest

Saturday, 2/21 - Prairie View A&M CDE Contest

March-

Friday, 3/1 - Clear Falls Evening Floral Contest - League City

Saturday, 3/2 - HLSR Contest

Thursday, 3/21 - Tarleton CDE Contest, Stephenville, TX - Overnight

Saturday, 3/23 - Last Chance Floral Contest, Rudder High School - College Station

Friday, 3/29 - WTAMU CDE Contest, Canyon, TX - Overnight

Saturday, 3/30 - PLANT ID Clarendon, TX - Overnight

April-

Wednesday, 4/3 - Heart of Texas - Waco

Saturday, 4/6 - AREA @ TAMU** This is the contest where the team can qualify for state.

Saturday, 4/27 - PLANT ID State Contest, TTU, Lubbock, TX

Nursery/Landscape

Practice Tuesdays & Wednesdays at 6:30am

January

Tuesday, 1/29 - Klein CDE Contest

February

Friday, 2/1 - Ridge Point CDE Contest

Saturday, 2/21 - Prairie View A&M CDE Contest

March

Saturday, 3/2 - HLSR Nursery/Landscape Contest

Thursday, 3/21 - Tarleton CDE Contest, Stephenville, TX - Overnight

Friday, 3/29 - WTAMU CDE Contest, Canyon, TX - Overnight

Saturday, 3/30 - Clarendon, TX - Overnight

April

Wednesday, 4/3 - Heart of Texas - Waco

Saturday, 4/6 - AREA @ TAMU** This is the contest where the team can qualify for state.

Saturday, 4/27 - State Contest, TTU, Lubbock, TX

Entomology

Practice Monday & Wednesday at 2:50pm

January

Saturday, 1/26 - Wildcard Invitational CDE Contest
(Weimar/Columbus)

Tuesday, 1/29 - Klein CDE Contest

February

Friday, 2/1 - Ridge Point CDE Contest

Sunday, 2/3 - Garrison Online Ento Contest

*meet at school

Saturday, 2/21 - Prairie View A&M CDE Contest

March

Thursday, 3/21 - Tarleton CDE Contest, Stephenville, TX -
Overnight

Friday, 3/29 - WTAMU CDE Contest, Canyon, TX -
Overnight

Saturday, 3/30 - AGRONOMY Clarendon, TX - Overnight

April

Wednesday, 4/3 - Heart of Texas - Waco

Saturday, 4/6 - AREA @ TAMU** This is the
contest where the team can qualify for state.

Saturday, 4/27 - AGRONOMY State Contest,
TTU, Lubbock, TX

Farm Business Management

January:

- Wildcard Invitational CDE Contest
 - January 26
- Klein Invitational CDE Contest (Online)
 - January 29

February:

- Ridge Point CDE Contest
 - February 1
- East Central FBM Contest (Online)
 - February 11
- Prairie View CDE Contest
 - February 21

Practice: Wednesday @ 6am

March:

- Tarleton State CDE Contest
 - March 21
- Texas State CDE Contest
 - March 29
- Texas A&M FBM Clinic
 - March 30

April:

- Heart of Texas CDE Contest (Waco)
 - April 3
- Area 3 CDE Contest (Huntsville)
 - April 16
- State CDE Contest (Huntsville)
 - May 3

Agriculture Technology and Mechanical Systems

Practice: Thursdays @ 6am

*Team will be finalized by Spring Break with a mock contest in the Ag Shop. Top 4 scores will compete on the team.

March:

- Texas State CDE Contest
 - March 29
- Texas A&M ATMS Clinic
 - March 30

April:

- Area 3 CDE Contest (Huntsville)
 - April 16

May:

- State CDE Contest (Huntsville)
 - May 3

wildlife

Tuesday: @ 6:15am

January:

- Wildcard Invitational CDE Contest
 - January 26
- Klein Invitational CDE Contest
 - January 29

February:

- Ridge Point CDE Contest
 - February 1
- San Antonio Livestock Show
 - February 12
- Prairie View A&M
 - February 21

March:

- Tarleton State University CDE Contest
 - March 21
- West Texas A&M CDE Contest
 - March 29
- Clarendon College CDE contest
 - March 30

April:

- Region III Contest Texas A&M Kingsville
 - April 4
- *State Wildlife CDE Contest Junction, Texas
 - April 23

Wool Judging

Friday: @ 6:30am

January:

- Wildcard Invitational CDE Contest
 - January 26
- Klein Invitational CDE Contest
 - January 29

February:

- Cy-Creek Invitational CDE Contest
 - February 26

March:

- Tarleton State CDE Contest
 - March 21
- West Texas A&M
 - March 29
- Clarendon College CDE Contest
 - March 30

April:

- Heart of Texas CDE Contest Waco, Texas
 - April 3
- Texas A&M Area CDE Contest
 - April 5 (Friday Afternoon)
- *State Wool Contest Lubbock, Texas
 - April 27

CDE Hotel Cost- San Antonio/ East Central Trip

- February 23rd-24th
 - Team attending-Livestock
 - Super 8 hotel- San Antonio, TX
 - \$109 per night x 4 rooms = \$436
 - 11 students (7 Cy-Ranch, 4 Cy-Fair) = \$39.64 per student
 - Student will pay half = \$19.82

CDE Hotel Cost- Tarleton Invitational

- March 16th - 17th

- Teams attending-

Wool

Wildlife

Horse

Vet. Med.

Poultry

Floral

Nursery

Ento

Livestock

Dairy Cattle

Meat

Holiday Inn Express - Granbury, TX

- \$99.51 per night x 10 rooms = \$995.10

- 45 students at \$22.11 per student

Student will pay half = \$11.00

CDE Hotel Cost- WT and Clarendon Trip

- Teams attending- West Texas A&M Contest

- Wool
- Wildlife
- Horse
- Vet. Med.
- Poultry
- Floral
- Ento
- Cotton
- Livestock
- Dairy Cattle
- Meats
- Nursery

Holiday Inn Express - Amarillo, TX - Night 1

- \$103.55 per night x 11 rooms = \$1139.00
 - 47 students at \$24.24 per student

Student will pay half = \$12.12

- Teams attending- Clarendon Invitational

- Wool
- Wildlife
- Horse
- Vet. Med.
- Poultry
- Floral
- Ento
- Cotton
- Livestock
- Dairy Cattle
- Meats
- Nursery

Best Western - Clarendon, TX

- \$123.12 per night x 11 rooms = \$1354.32
 - 47 students at \$28.82 per student

Student will pay half = \$14.41

CDE Hotel Cost

Includes CDE trip hotel stays

Total students would pay with half of the cost paid for:

\$57.40 - Livestock

Payment Due February 15th.

Cash, Cashier's Check, or Money Order made out to CFISD.

\$37.59

Vet Med

Wool

***These cost do not include the Texas Tech State

Contest***

Horse

Floral

Poultry

Ento

Dairy Cattle

Meats

Nursery

Wildlife